

WELD-FIT SPLICER SLEEVE

S - 20000 WF

Fillet Weld
Top & Bottom

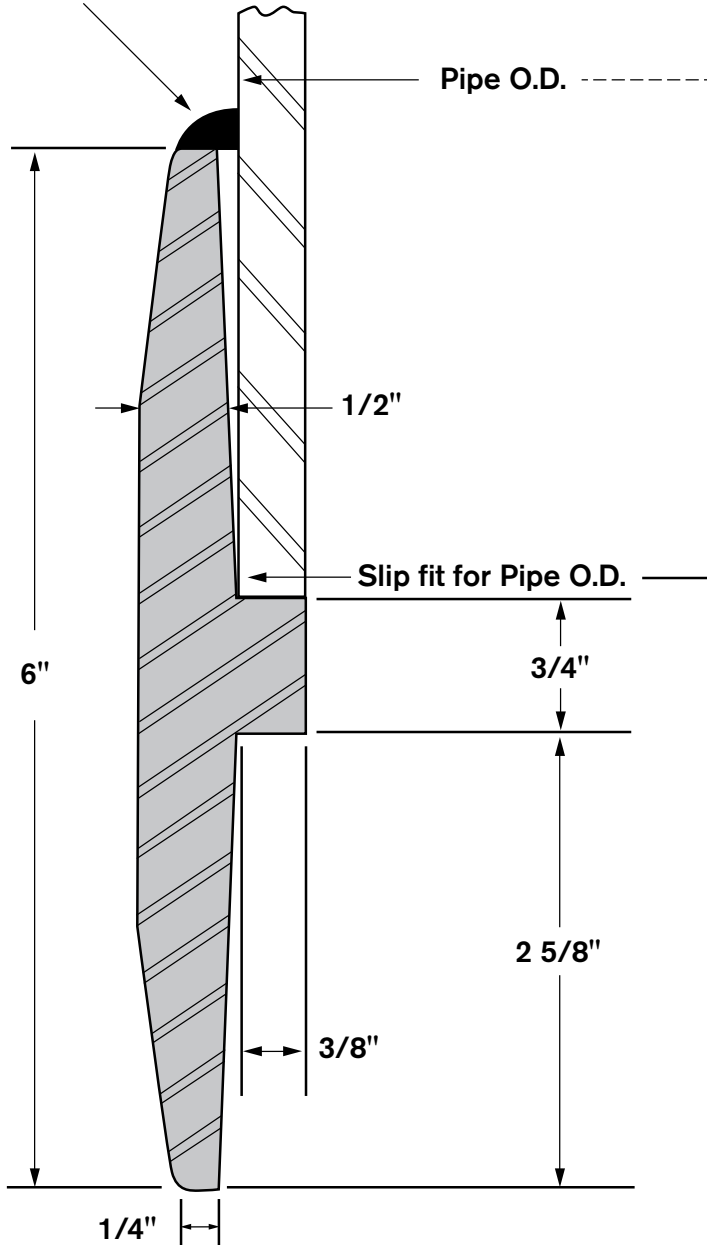

MATERIAL: CAST STEEL

ASTM A148 90/60

SECTION THROUGH PIPE AND SPLICER.
NORMAL FOUNDRY TOLERANCES APPLY.

| PIPE O.D. | WEIGHT |
|-----------|--------|
| 7 5/8" | 23# |
| 8 5/8" | 19# |
| 9 5/8" | 31# |
| 10 3/4" | 28# |
| 12" | 31# |
| 12 3/4" | 31# |



**ASSOCIATED PILE
& FITTING**

45 Samworth Road, Clifton, NJ 07014
 Tel: 973-773-8400
 Fax: 973-773-8442
 email: apf@associatedpile.com
www.associatedpile.com
 Call Toll Free: 800-526-9047

WELD-FIT SPLICER SLEEVE

20000 WF 13-5/8"

Fillet Weld
Top & Bottom

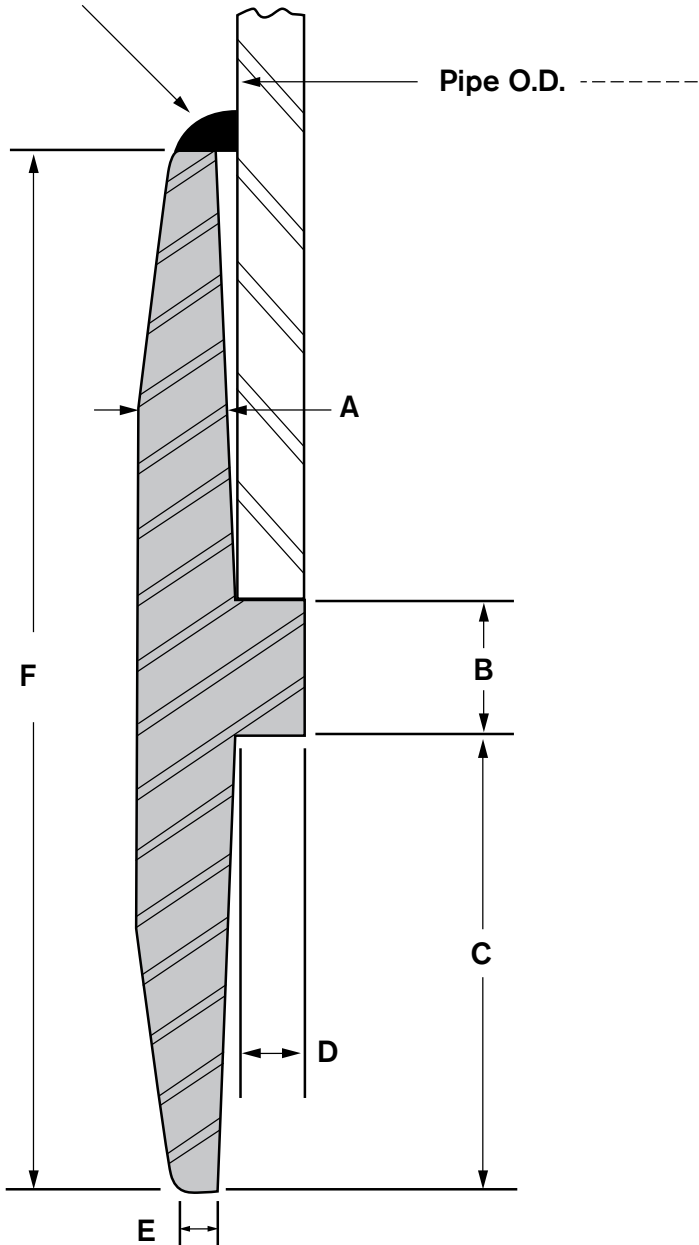

MATERIAL: CAST STEEL

ASTM A148 90/60

Weight: 51#

SECTION THROUGH PIPE AND SPLICER.
NORMAL FOUNDRY TOLERANCES APPLY.

| | |
|----------------------|-----------|
| A | 1/2" |
| B | 3/4" |
| C | 2 5/8" |
| D | 7/8" |
| E | 5/16" |
| F | 6" |
| Dim. at Ledge | 13 13/16" |
| Wt | 51# |

NOTE: This splicer is machined from the 13-3/8" Drive On S-20000



**ASSOCIATED PILE
& FITTING**

45 Samworth Road, Clifton, NJ 07014
 Tel: 973-773-8400
 Fax: 973-773-8442
 email: apf@associatedpile.com
 www.associatedpile.com
 Call Toll Free: 800-526-9047

WELD-FIT SPLICER SLEEVE

S - 20000 WF 16"

Fillet Weld
Top & Bottom

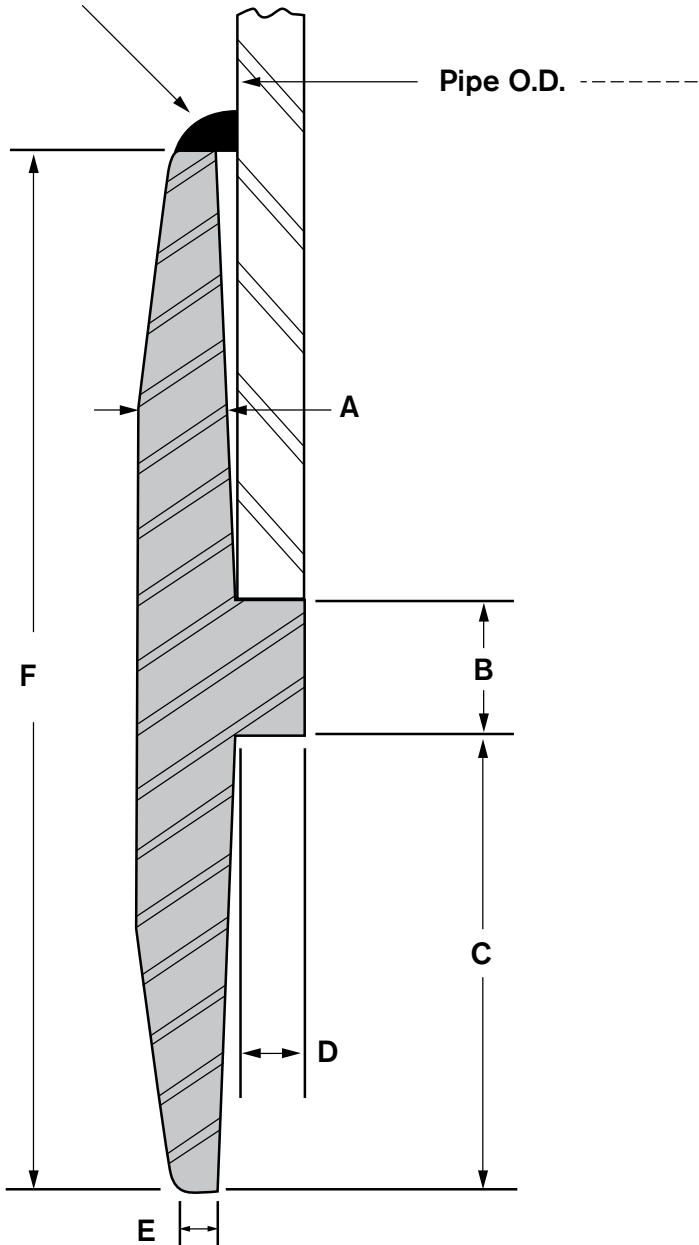

MATERIAL: CAST STEEL

ASTM A148 90/60

Weight: 42#

SECTION THROUGH PIPE AND SPLICER.
NORMAL FOUNDRY TOLERANCES APPLY.

| | |
|----------------------|----------|
| A | 3/8" |
| B | 3/4" |
| C | 2 5/8" |
| D | 1/2" |
| E | 1/4" |
| F | 6" |
| Dim. at Ledge | 16 3/16" |
| Wt | 42# |



**ASSOCIATED PILE
& FITTING**

45 Samworth Road, Clifton, NJ 07014

Tel: 973-773-8400

Fax: 973-773-8442

email: apf@associatedpile.com

www.associatedpile.com

Call Toll Free: 800-526-9047

WELD-FIT SPLICER SLEEVE

S - 20000 WF 18"

Fillet Weld
Top & Bottom

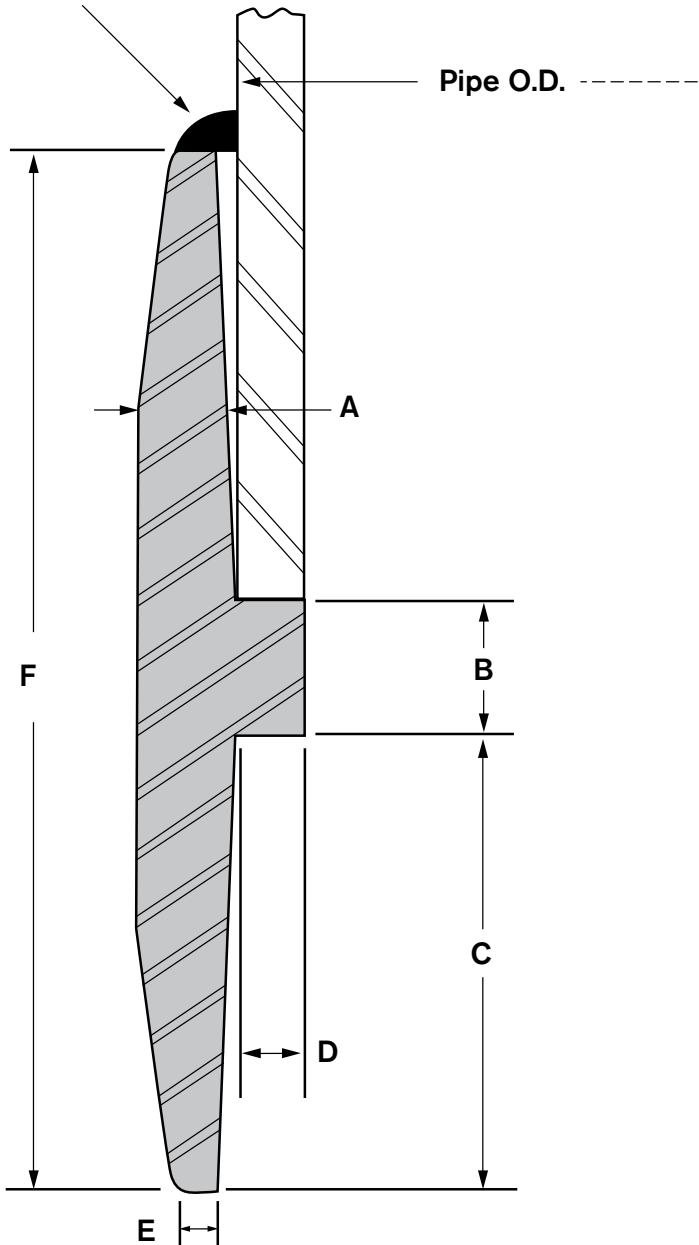

MATERIAL: CAST STEEL

ASTM A148 90/60

Weight: 52#

SECTION THROUGH PIPE AND SPLICER.
NORMAL FOUNDRY TOLERANCES APPLY.

| | |
|----------------------|----------|
| A | 1/2" |
| B | 3/4" |
| C | 2 5/8" |
| D | 3/4" |
| E | 3/8" |
| F | 6" |
| Dim. at Ledge | 18 3/16" |
| Wt | 52# |



**ASSOCIATED PILE
& FITTING**

45 Samworth Road, Clifton, NJ 07014

Tel: 973-773-8400

Fax: 973-773-8442

email: apf@associatedpile.com

www.associatedpile.com

Call Toll Free: 800-526-9047

WELD-FIT SPLICER SLEEVE

S - 20000 WF 20"

Fillet Weld
Top & Bottom

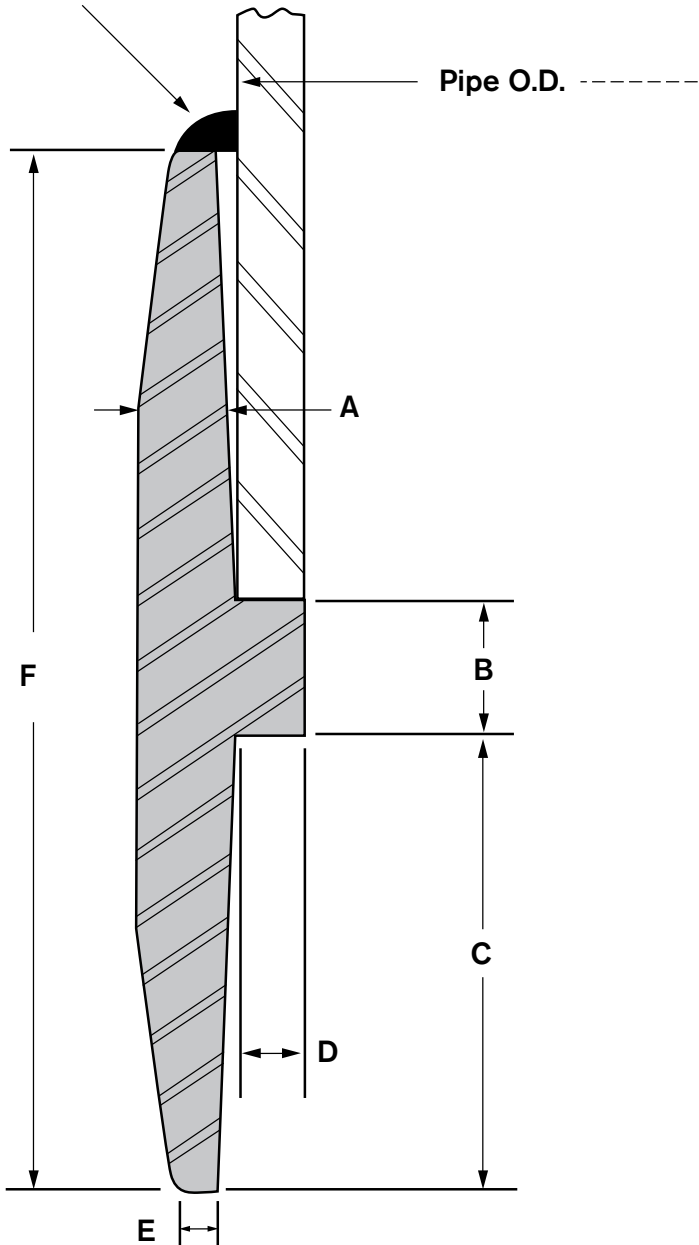

MATERIAL: CAST STEEL

ASTM A148 90/60

Weight: 83#

SECTION THROUGH PIPE AND SPLICER.
NORMAL FOUNDRY TOLERANCES APPLY.

| | |
|----------------------|----------|
| A | 3/4" |
| B | 1" |
| C | 2 1/2" |
| D | 3/4" |
| E | 1/2" |
| F | 6" |
| Dim. at Ledge | 20 3/16" |
| Wt | 83# |



**ASSOCIATED PILE
& FITTING**

45 Samworth Road, Clifton, NJ 07014

Tel: 973-773-8400

Fax: 973-773-8442

email: apf@associatedpile.com

www.associatedpile.com

Call Toll Free: 800-526-9047

WELD-FIT SPLICER SLEEVE

S - 20000 WF 24"

Fillet Weld
Top & Bottom

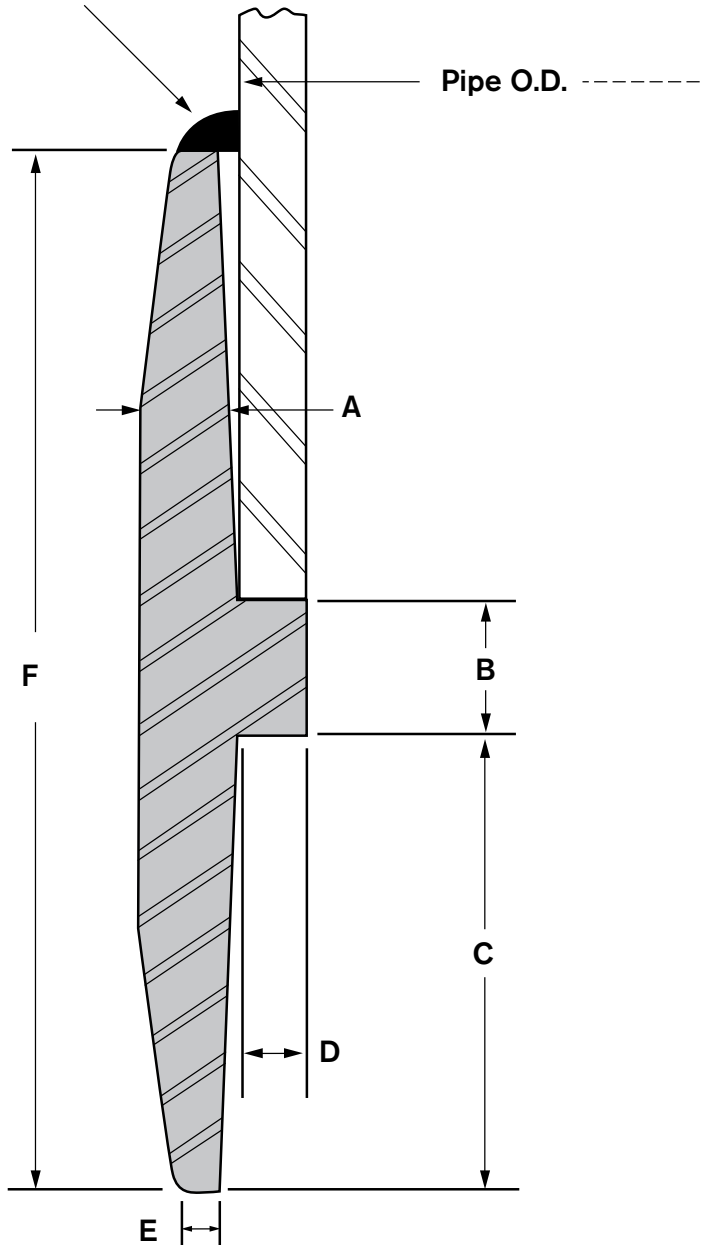

MATERIAL: CAST STEEL

ASTM A148 90/60

Weight: 96#

SECTION THROUGH PIPE AND SPLICER.
NORMAL FOUNDRY TOLERANCES APPLY.

| | |
|----------------------|----------|
| A | 3/4" |
| B | 1" |
| C | 2 1/2" |
| D | 3/4" |
| E | 1/2" |
| F | 6" |
| Dim. at Ledge | 24 3/16" |
| Wt | 96# |



**ASSOCIATED PILE
& FITTING**

45 Samworth Road, Clifton, NJ 07014

Tel: 973-773-8400

Fax: 973-773-8442

email: apf@associatedpile.com

www.associatedpile.com

Call Toll Free: 800-526-9047